



Beijing KBB Automated Entrances Inc.
(Headquarter Office)

Add: No.22 Shui Ku Road, Changping District, Beijing, China 102200

Tel: 8610 69748800

Fax: 8610 69745747

Email: service@kbb.com.cn

Shenyang KBB Automated Entrances Inc.

Add: No.117 Shen Bei Road, Hu Shi Tai High-tech Development Zone,
Shenyang, China 110122

Tel: 8624 89718800

Fax: 8624 89718800

Email: service@kbb.com.cn

Ningbo KBB Automated Entrances Inc.

Add: Jiang Bei Investment Pioneering Park, Ningbo, China 315038

Tel: 86574 87565800

Fax: 86574 87565898

Email: service@kbb.com.cn

KBB International Co., Ltd.

Add: Room A-1109, No.72 North Road of West 3rd Ring, Haidian
District, Beijing, China 100048

Tel: 8610 88825668

Fax: 8610 88825668 ext 300

Email: info@kbb.com.cn



www.kbb.com.cn



KS/ KH Series Intelligent Access Solutions for Green Hospitals

Intelligent Access Solutions for Green Hospitals

- Automatic and intelligent
- Preventing cross-infection
- Ensuring clear passage

Hermetic Sliding Door for Operating Room

Standard and curved hermetic sliding doors for operating rooms meet strict requirements for door airtightness by operating rooms. Customers can choose different styles of doors at their discretion.



Radiation-resistant Hermetic Sliding Door

Radiation-resistant hermetic sliding doors at different levels follow requirements and standards for radiation resistance and door airtightness strictly, applicable for highly hermetic places like X-ray rooms, CT rooms and labs. Customers can select different styles of doors at their discretion.



Main Entrance

KBB offers 4 solutions for main entrances, namely revolving door, telescopic sliding door, sliding door and curved sliding door, and more options for customers.

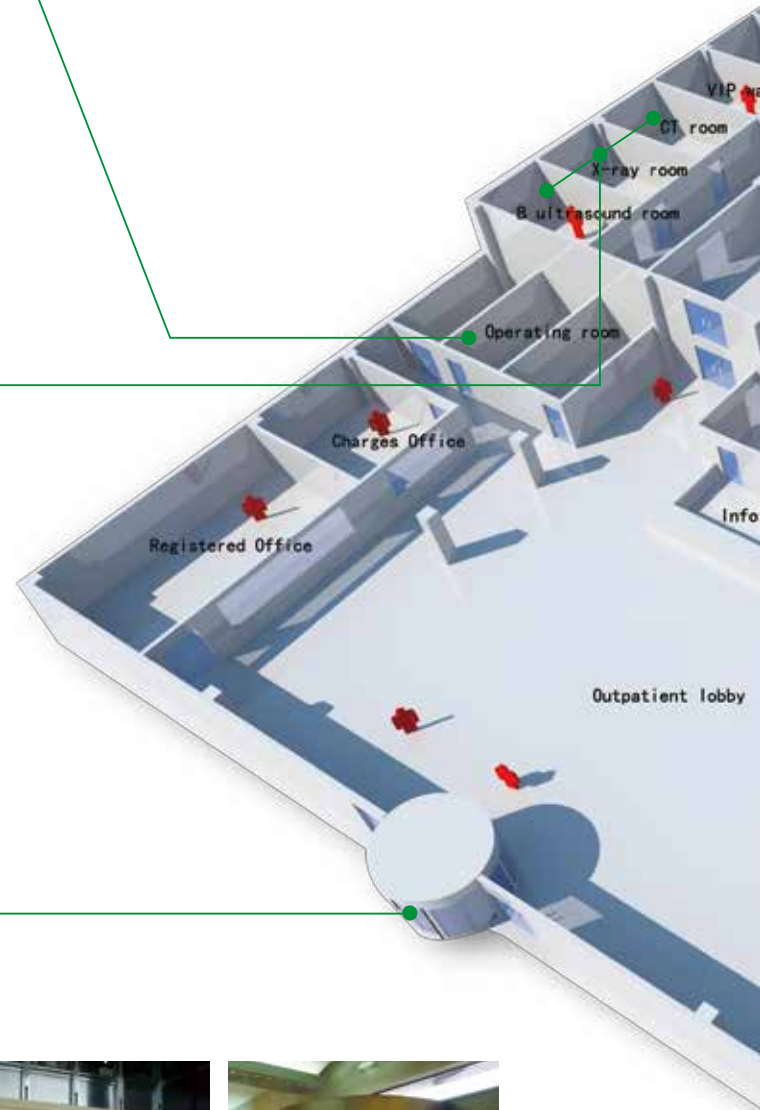

- Clean and energy-saving
- Effective in obstruction of dissemination via air
- Professional in hermetic radiation-resistance

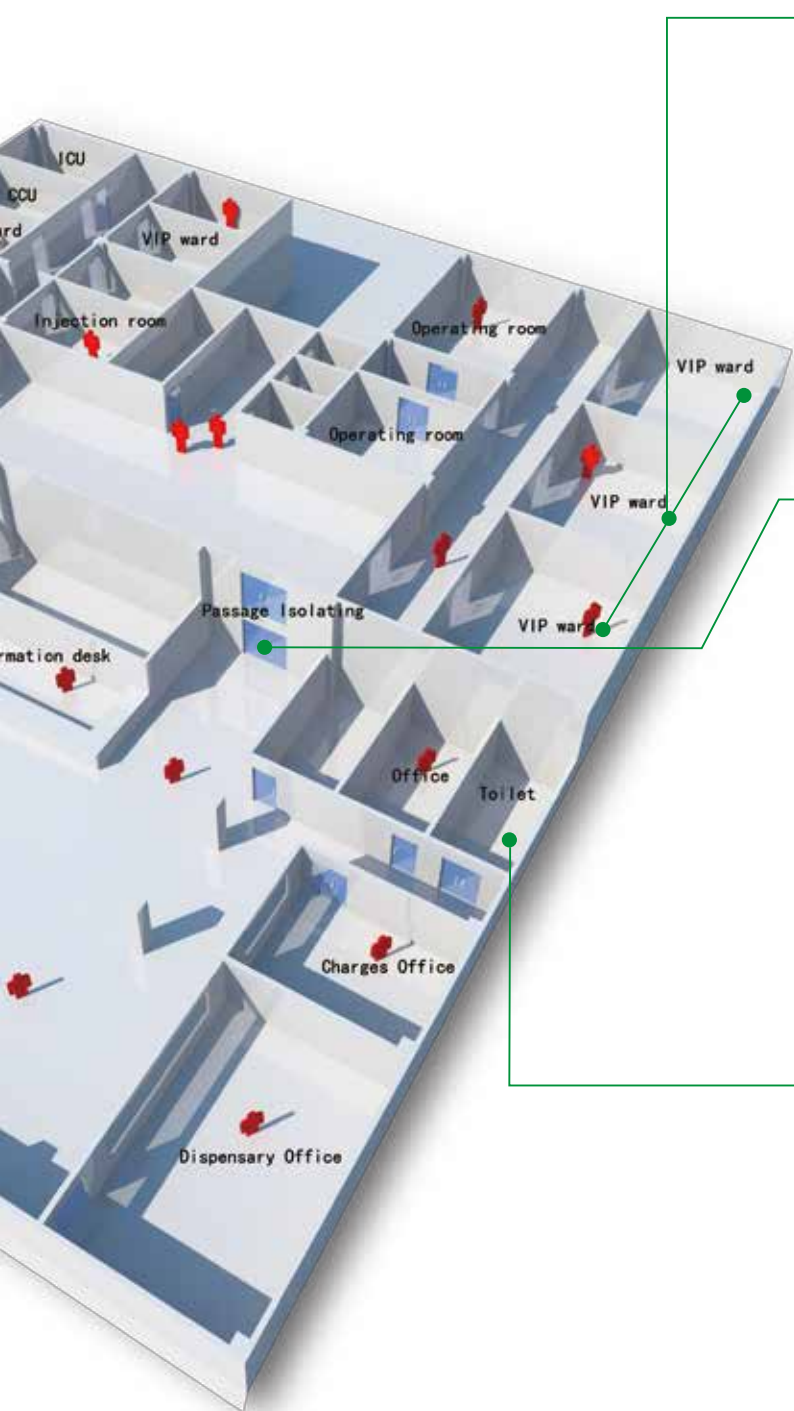

Ward Door

The ward doors specially designed for ICUs, CCUs and other special wards of hospitals adopt a massive glass structure to meet care requirements for clear observation of patients.



Passage Isolating Door

It can meet function needs for different occasions to effectively make sure of clear passage of wheelchairs, hospital trolleys and disabled patients and avoid cross infection of bacteria; and also can function for effective isolation and authorized passage in such places as ward sections.



Lavatory Door

Common lavatory doors and special lavatory doors for the disabled designed by KBB facilitate medical care personnel and patients and avoid cross infection of bacteria effectively.



Automatic Revolving Door

KA220 and KA210 are two-wing automatic revolving doors with noble appearance, stable and reliable operation, fine workmanship and safe use, which have all along been the best choice for main entrances of various buildings.

The unique "3-in-1" design, combining revolving doors, sliding doors

and balanced doors, integrates those functions as energy saving, environment-friendliness, easy passage and emergency evacuation safety, which is particularly applicable for complex environment demand of main entrances, and can fully meet the design requirements for green hospitals.



3-in-1 Functions

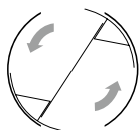

Revolving Door Function

The revolving door is designed to completely isolate interchange of indoor and outdoor air, thus minimizing energy losses caused by heat exchange.

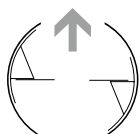

Sliding Door Function

When weather is pleasant, traffic is heavy or massive objects pass, open the sliding door between two-wing doors to maximize the passage capacity easily.

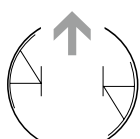

Balanced Door Function

The two-wing door with 3-in-1 functions embodies elegance, energy saving, convenience and immediacy of a sliding door. In case of emergencies, balanced door can realize the maximum evacuation width of the door area.

Model	KA210	KA220
Inner Diameter	3600~4800mm	3600~4800mm
Outer Diameter	3684~4884mm	3088~4888mm
Canopy Height	280mm	300mm
Clear Passage Height	2500mm	2200~3000mm

Telescopic Sliding Door



KS4000 telescopic sliding door is an automatic door product with powerful functions, reliable performance and super-mute operation. It maximizes the opening width of the passage entrance with a unique operation mode, which can make sure of smooth passage in heavy traffic, and provide an easy and clean passage space for massive objects. It's particularly applicable for main entrances and first aid passages of hospitals.

Panic Breakout

Both sliding and fixed leaves of KS4000 telescopic sliding door can be pushed off at any time, thus it ensures the maximum passage space of the entrance in case of evacuation in emergencies or passing of massive objects.

Model	KA210
Operator Height	200mm
Operator Width	200mm
Door Width	≥ 4000~7000mm
Width	2000~5000mm
Maximum Door Weight	200kg(Single Part), 240kg(Bi-part)



Single open state



Double open state

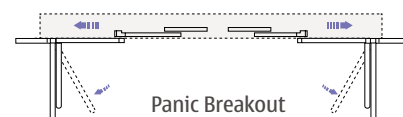

Panic Breakout

Automatic Sliding Door

Characterized by their advanced structural design, powerful functions, excellent performance, high reliability, and high cost-effectiveness, KS1000 and KS3000 automatic sliding doors have been highly recognized by customers worldwide, and are widely applied in many big famous projects in the world, such as Terminal 3 of Beijing Capital International Airport, Chinese Pavilion

of 2010 Expo Shanghai, Water Cube -2008 Beijing Olympics and Shanghai Maglev Station. The products are exported to more than 60 foreign countries, particularly applicable for main entrances, ward section entrances, lavatory entrances and first aid passages of hospitals.



Panic Breakout

Both sliding and fixed leaves of KS1000 and KS3000 automatic sliding doors can be pushed off at any time, thus providing the maximum passage space of the door area in case of evacuation in emergencies or passing of massive objects.

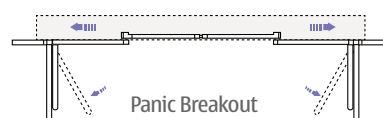

Model	KS1000	KS3000	KS6100	KSP8A	KSP8B
Passage Width	800~3000mm	800~3000mm	750~3000mm	750~3000mm	750~2400mm
Passage Height	≤3000mm	≤3000mm	≤3000	≤3000	≤2400
Operator Width	165mm	185mm	114mm	130mm	130mm
Operator Height	200mm	105mm	200mm	140mm	89mm
Door Width	3600~6000mm	3600~6000mm	3600~6000mm	3600~6000mm	3600~5000mm
Maximum Door Weight	120x2kg	120x2kg	140x2kg	120x2kg	80x2kg

Curved Automatic Sliding Door

KC1000 curved automatic sliding door integrates many advantages of automatic revolving and sliding doors, featuring attractive appearance, powerful functions, excellent performance, safety and reliability. The curved design can not only meet needs for clear passage during heavy traffic and of disabled patients and medical equipment, but also save energy effectively, which is particularly applicable for main entrances of hospitals.

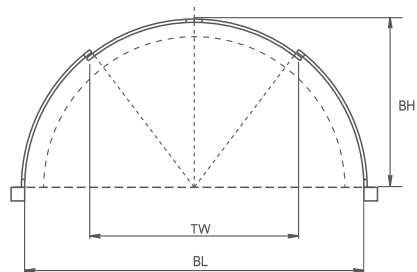
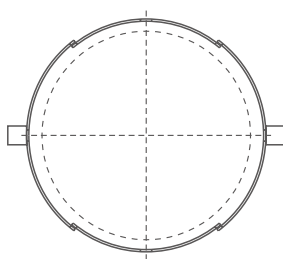

TW — Opening width
BL — Chord length
BH — Chord

* The radius of the product can be adjusted based on different requirements.

Hermetic Door KH2000

KH2000 is the newest hermetic sliding door launched by KBB in 2012. Its improved and upgraded operating system is more stable, reliable and hermetic. Diversified appearance and specially designed styles overturned traditional design concepts, thus making a more comfortable and elegant environment of medical hospitals treatment.

Reliability

Motors + reducers imported from Germany, Philips chip board, 5mm-thickness high-strength supporting beams and highly wear-resistant and self-lubricating bearing rollers.

Safety

The automatic reversal, anti-squeeze and force-sensitive function, the anti-squeeze safety light barrier can open the door and stop automatically after identifying of persons/things intelligently, the high-capacity battery backup system can maintain 30-minute operation of the automatic door when it's de-energised, and then performing the manual function easily when the door is de-energised or goes wrong.

Super-mute

Designed with high-frequency PWM drive, mute nylon track rail and aluminum alloy forming gear.

Attractive Appearance

Designed with unique high-strength glass panel, elegant curved and fold line appearance, refined body closing indicator lamp.

Airtightness

By the unique rail design, the door can move by 10mm downwards and inwards; and a superb standard hermetic effect is guaranteed by right of a structure consisting of special silica gel sealing strips and polyurethane foaming around the door.

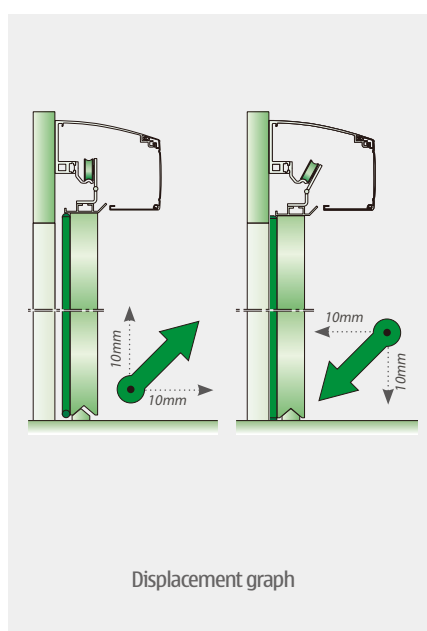
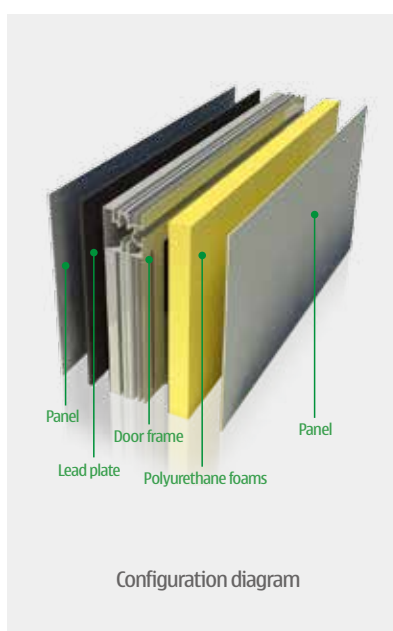

KH2000A — Standard Hermetic sliding door for Operating Room



- ① Its panel is made of high-strength glass looks fashionable and bright, with a great variety of colors; no dust deposited faces, easy for cleaning and with a strong resistance to wearing (strength of glass is far higher than that of aluminum and fireproof plates).
- ② There are 8 indicator lamps installed on the bottom of the door, indicating the door's status of sealing and indoor working; and the original indicating system highlights a modern sense of door design.

	Standard	Optional		
Surface Material	8mm Tempered glass	2mm aluminum plate	Stainless steel plate	Other materials
Surface Treatment	High-temperature emulsification painting	Spray	Nature color/plating color	Other
Anti-Collision Belt	N/A	Available	N/A	Available
Observation Window	Available	Available	Available	Available
Clear Passage Width	600~1500mm			
Clear Passage Height	2100~2600mm			

Note: Design and specifications are subject to change without notice, as they are based on product development.

KH2000B—Curved Hermetic Sliding Door



- 1 Its unique integrated curved face design makes the door more resistant to bumping meanwhile showing a hi-tech sense.
- 2 Its panel is made of high-strength glass has a strong resistance to wearing; looks fashionable and bright, with a great variety of colors; and no dust deposited faces, easy for cleaning.
- 3 There are 8 indicator lamps installed on the bottom of the door; indicating the door's status of sealing and indoor working; and the original indicating system highlights a modern sense of door design.
- 4 The integration design style of its big observation window reduces more dust depositing, easy for cleaning with less bacterial contamination.

	Standard	Optional		
Surface Material	8mm Tempered glass	2mm aluminum plate	Stainless steel plate	Other materials
Surface Treatment	High-temperature emulsification painting	Spray	Nature color/plating color	Other
Anti-Collision Belt	N/A	Available	N/A	Available
Observation Window	Available	Available	Available	Available
Clear Passage Width	600~1500mm			
Clear Passage Height	2100~2600mm			

Note: Design and specifications are subject to change without notice, as they are based on product development.

KH2000C — Radiation-resistant Hermetic Sliding Door



- ① With unique fold line design for the door shape, the door adopts a stainless steel panel to make it more resistant to bumping.
- ② It uses a 2mmpb foaming door body inside to shield radiation effectively.
- ③ There are 8 indicator lamps installed on the bottom of the door, indicating the door's status of sealing and indoor working; and the original indicating system highlights a modern sense of door design.
- ④ A radiation-resistant mark is provided on the operator.

	Standard	Optional		
Surface Material	1.2mm Stainless steel plate	2mm aluminum plate	Stainless steel plate	Other materials
Surface Treatment	Nature color	Spray	Plating color	Other
Anti-Collision Belt	N/A	Available	N/A	Available
Observation Window	Lead glass	Lead glass	Lead glass	Lead glass
Lead Protection	1 lead equivalent	2~4 lead equivalent	2~4 lead equivalent	2~4 lead equivalent
Clear Passage Width	600~1500mm			
Clear Passage Height	2100~2600mm			

Note: Design and specifications are subject to change without notice, as they are based on product development.

Intelligent Access Solutions for Green Hospitals

Ward Door KS1000-H

KS1000-H is a product line specially designed to meet needs for ICUs and CCUs of hospitals. Its glass design makes clear observation to patients; and ample natural light makes a pleasant environment for patients.



- 1 Its single leaf sliding design with mid rail can reduce bumping effectively while such objects as ward beds and devices passing through it.
- 2 Its big and clear glass design improves the natural lighting rate, saving energy, creating a natural and comfortable space and making medical care personnel much easier to know the conditions of patients. The door can also use frosted semi-transparent glass to enhance privacy.
- 3 The external call indicating system (indicator lamps on the door bottom) can provide lighting in the evening and also more visual prompts for medical care personnel for fast response to calls of patients.
- 4 It has optional function to work together with a fire alarm system ensuring automatic opening in emergencies.

Passage Width	800~3000mm
Passage Height	≤3000mm
Operator Width	165mm
Operator Height	200mm
Width Of Cave	3600~6000mm

Swing Door KP3000-H

KBB swing door adopts intelligent and user-friendly design, with good operability and reliability. The door can be opened at 90°, making sure of fast evacuation of people when necessary.



- ① Its swing door design mode guarantees the maximum effective opening width, facilitating patients and medical care personnel and preventing cross infection of virus caused by direct contact with the door.
- ② Double felt strip sealing in the middle and O-shape adhesive tape sealing around isolate the space effectively and a good sealing effect.
- ③ It's provided with a built-in transformer and a battery backup system.
- ④ It has optional function to work together with a fire alarm system to make sure of automatic opening of the door in emergencies.
- ⑤ The door can be opened or closed easily through the manual mode when it's de-energised.

Model	Maximum Door Weight	Maximum Load-bearing	On/off Mode	Bracket
KP3000-HS	≤3000mm	100kg	Motor on / off	Sliding arm / joint arm
KP3000-HWE	165mm	100kg	Motor on / spring off	Sliding arm / joint arm
KP3000-HWS	200mm	250kg	Motor on / spring off	Sliding arm / joint arm

Lavatory Automatic Sliding Door KS1000-W

KBB lavatory automatic sliding door meets the highest standard of hospitals for the environmental health. The door receives sense signals to open or close automatically to avoid dangers of contagious infection.



- ❶ The entire door is made of 6+6+6mm laminated glass, maximizing its resistance to bumping; and the all-glass design makes it easier for cleaning.
- ❷ Its big observation window increases the indoor lighting rate.
- ❸ Its light and simple design style highlights a modern and fashionable sense.
- ❹ Its contact-free opening mode reduces cross infection of germs.

Passage Width	800~3000mm
Passage Height	≤3000mm
Operator Width	165mm
Operator Height	200mm
Width Of Cave	3600~6000mm

Projects

Beijing Cancer Hospital
 Beijing Jishuitan Hospital
 People's Liberation Army Second Artillery General Hospital
 Shanghai Pudong New Area Gongli Hospital
 Shanghai Humanity Hospital
 Shanghai Putuo District Center Hospital
 Shanghai Luwan District Center Hospital

Shanghai Ruijin Hospital
 Hangzhou Sir Run Run Shaw Hospital
 Hangzhou Qingchun Hospital
 Tianjin Central Hospital of Gynecology Obstetrics
 The People's Hospital of Bozhou
 Changsha Tumour Hospital
 Changsha No.5 People's Hospital
 The Second Xiangya Hospital of Central South University
 The First Affiliated Hospital of Harbin Medical University
 The Second Affiliated Hospital of Harbin Medical University
 Harbin First Hospital
 Changchun Second Hospital
 Suihua First Hospital
 Jilin Yanbian Hospital
 Shengjing Hospital of China Medical University
 First Affiliated Hospital of Dalian Medical University
 The First Affiliated Hospital of Soochow University
 Wuhan Union Hospital

